



PROJECT		REF		REV	ITEM CODE	
LOCATION		DATE			PAGE	

SANITARY WARE SPECIFICATION SHEET

Item Descriptions	GROHE (Germany) "BauEdge" Chrome plated single-lever free standing basin mixer 1/2 " XL-Size; nominated flow rate 5 L/min in WELS Grade 1 ; Registration No. TN 21-0083	Illustration/ Drawing
Dimensions	L89 x W43 x H340 mm	
Model	32860000	
Finish	Chrome Plated	
Manufacturer	GROHE Limited	
Supplier	Acme Sanitary Ware Co. Ltd Mr. Eric Wong/ Mr. Don Yuen	
Contact Tel/Fax E-mail Website	(852) 2388-7171 / (852) 2710-8012 acme@acmesanitary.com.hk www.acmesanitary.com.hk	
"BauEdge" <u>Single-lever basin mixer 1/2 " XL-Size</u> <ul style="list-style-type: none"> • for free standing basins • metal lever • GROHE Longlife 28 mm ceramic cartridge • GROHE StarLight chrome finish • mousseur • pop-up waste set 1 1/4" • flexible connection hoses • rapid-installation-system 		

Note:

* All information of the above is for the reference only. No prior notice is made if any changes.



PROJECT		REF		REV	ITEM CODE	
LOCATION		DATE			PAGE	

SANITARY WARE SPECIFICATION SHEET

GROHE BAUEDGE

CONSISTENT USE OF LOZENGE SHAPES

Lends an air of balance and harmony. BauEdge's modern silhouette of the lever handle is pitched at an angle of seven degrees for comfortable use without compromising the clarity of its form. A comprehensive range of faucets and showers ensures this sophisticated design meets your design requirements.

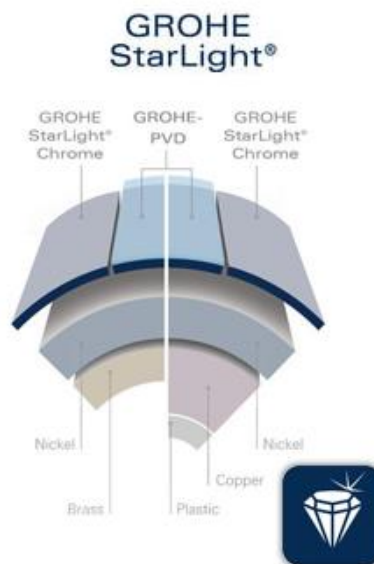
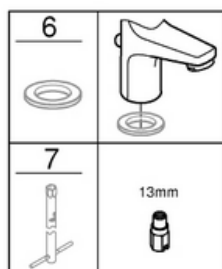
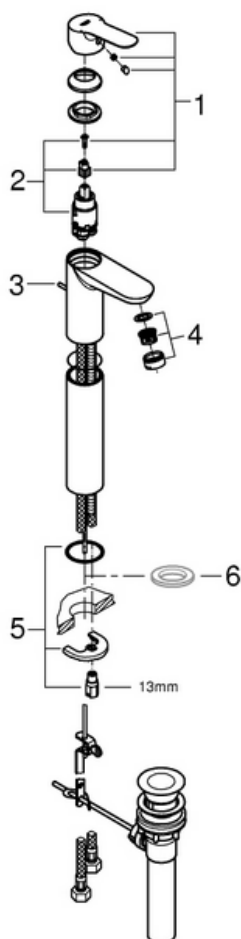

Easy to clean thanks to the GROHE StarLight chrome coating

Just wipe the tap down with a dry cloth – the ultra smooth surface finish is scratch resistant and ensures a lasting luminous sheen. You'll save plenty of time cleaning while your tap always looks shiny and new.

Pos.-nr.	Prod. description	Order-nr.
1	Lever	46697000
2	Cartridge	46580000
3	Pop-up rod	10769000
4	Mousseur	13952000
5	Shank fastening assembly	46249000
6	Base plate	48052000*
7	Mounting wrench	19017000*

* Optional accessories

Note:

* All information of the above is for the reference only. No prior notice is made if any changes.



自願參與用水效益標籤計劃 - 水龍頭
Voluntary Water Efficiency Labelling Scheme - Water Taps

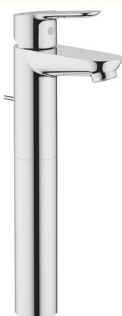

茲證明
This is to certify that

將下列水龍頭在本計劃內註冊：
has registered the following water tap under this scheme :

牌 子 / Brand	:	Grohe
型 號 / Model	:	32860XXX + 64647040
種 類 / Type	:	Mixing
原產地 / Country or Region Origin	:	Thailand (Mixer) Germany (Flow Controller)

XXX – denotes the code of colour

在用水效益標籤上展示的標誌 <i>Symbolic Presentation on the Water Efficiency Label</i>	:	 滴水點 <i>Water droplet(s)</i>
用水效益級別 <i>Water Efficiency Grade</i>	:	1
耗水量 <i>Water Consumption</i>	:	5.0 公升/分鐘 <i>litres/minute</i>

簽發日期：
Date of Issue: 22 March 2021



水務署
Water Supplies Department



水務署署長(張業駒代行)
for Director of Water Supplies



水務署
Water Supplies Department

總部 Headquarters



告士打道七號入境事務大樓 48 樓

ation Tower, 7 Gloucester Road, Wan Chai, Hong Kong

本署
Our ref.
來函檔號
Your ref.

321/2020 T/J(1208/2020)

電話 :
Tel.
傳真 : 2824 0578
Fax.

4 November 2020

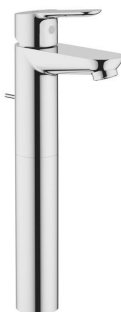

Approval of "GROHE" Basin Mixer
(General Acceptance No. C20200991)

Your letter ref. WRC/2347 dated 4 September 2020 and subsequent clarification by email on 21 October 2020 refer.

Having considered the test report ref. J24978A issued on 9 April 2020 by Nutek Systems (HK) Ltd., this Authority accepts that the fitting described below complies with, and its use when correctly installed does not contravene, the Waterworks Ordinance and Regulations.

Name of Manufacturer: Grohe AG

Country of Origin: Thailand

Brand: Grohe

Details of Fitting: 1/2" Single lever basin mixer

Model: 32860XXX
(where the digits "XXX" denote the code of colour)

Body Markings: 

Expiry Date: 19 January 2025



This Authority hereby permits the use of the above fitting in fresh water plumbing systems subject to full adherence to Waterworks installation requirements. In particular, you are required to draw your customers' attention to the following requirement-

"The cold water supply to the fitting shall be drawn from the same source that supplies the hot water apparatus so as to provide a balanced pressure and to obviate the risk of scalding in the event of a restriction or failure in the water supply."

A condition of this acceptance is that the fitting to be installed shall be replicas of the sample as certified by the testing agent mentioned above and without modifications. This acceptance may be withdrawn at any time if the standard of the fitting installed fails to meet that of the approved sample or if the fitting is found to be unsuitable for use in fresh water plumbing systems.

This acceptance is only applicable to the main body of the fitting, unless otherwise specified.

For the use of the fitting in any project, the General Acceptance Number of this letter must be quoted as a means of identification of acceptance of the fitting by this Authority.

Should you have any enquiries, please contact our Engineer Mr. Terry KUNG at tel. no. 3583 4086.

Yours faithfully,



(CHAN Chung-kun)

for Director of Water Supplies

Encl.

c.c. WSD 3321/1/82] - without catalogue
 ME/MC] - with soft copy only